

UTAH HOME BUILDERS

HARD LINE USA
110 W 13775 S #6

JACK SERDAR
PLUMBING
76 W 13800 S

13766 S PONY
EXPRESS RD

ROAD CROSSING
(40')

PROPOSED HANDHOLE

13800 S

PROPOSED 1.25" CONDUIT

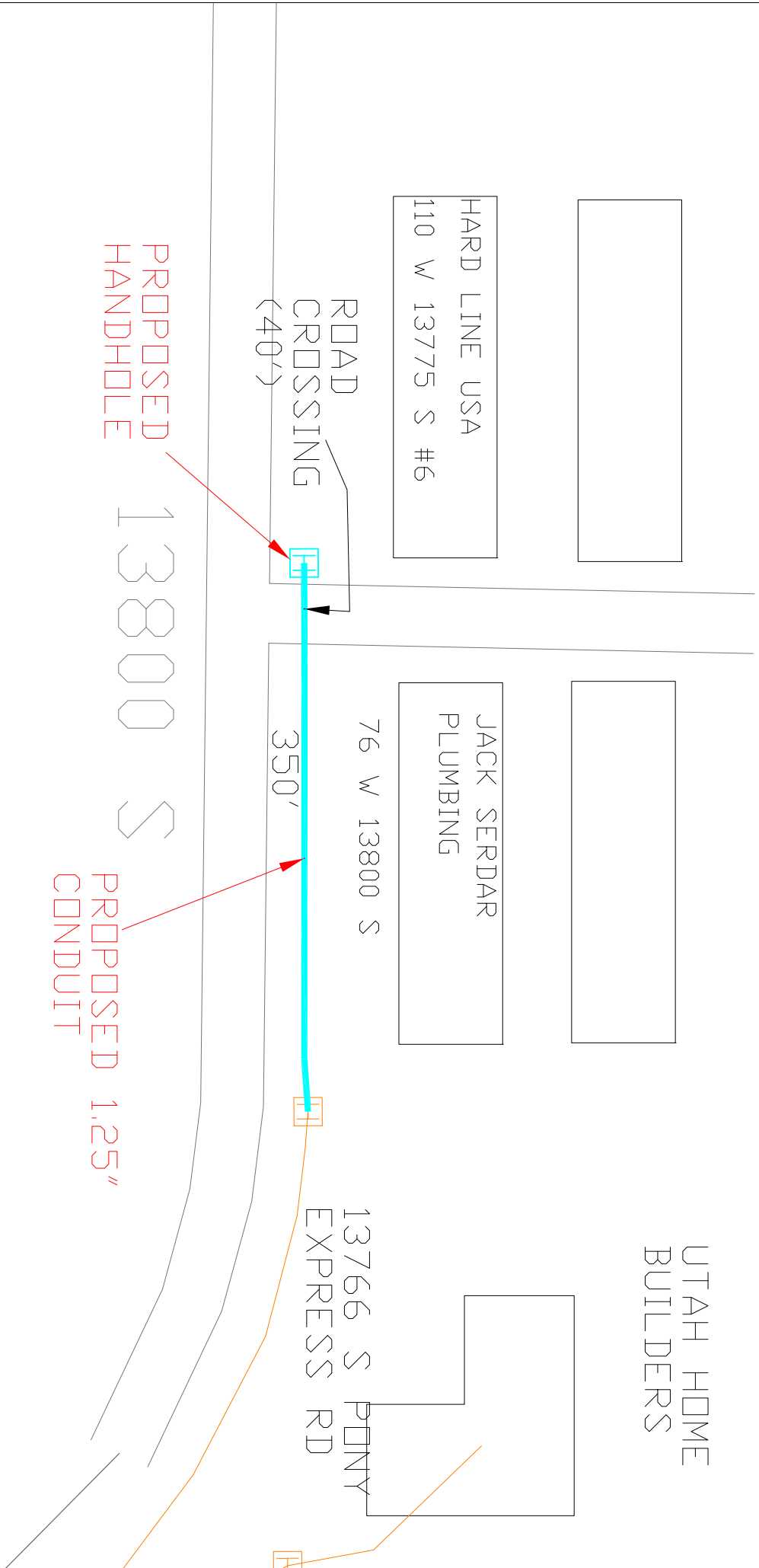

CentraCom, MC188123_MC188136: Proposed conduit path to Jack Serdar Plumbing and Hard Line USA, 76 W 13800 S and 110 W 13775 S, Draper, UT.

