

SANTAQUIN CITY CORP

SANTAQUIN CITY CORP

1215 N CENTER ST

PROPOSED HANDHOLE

192'

PROPOSED HANDHOLE

592'

PROPOSED 1.25" CONDUITS (2)

PROPOSED HANDHOLE

ROAD CROSSING (24')

50'

546'

PROPOSED CONDUITS:  
2-1.25"  
1-1.5"

500'

CENTER ST

RAILROAD  
MP SHARP 732  
6" CASING UNDER  
RAILROAD

APPLE HOLLOW

GINGER GOLD

GINGER GOLD

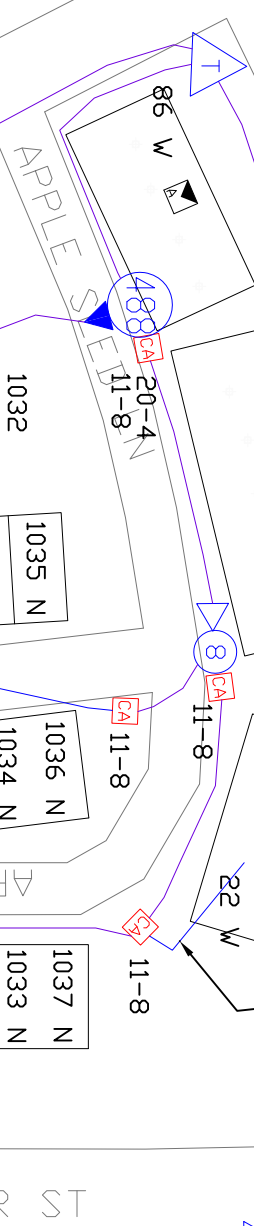

CentraCom, MC17857: Proposed conduit path to Santaquin City Corp Buildings, 1215 N Center Street, Santaquin, UT.

