

12 FIBER IN
1.25" CONDUIT

400 North (Community Center Way)

ROAD CROSSING (20')

412'

PROPOSED 1.25"
CONDUIT

MAPLETON CITY HALL
125 W 400 N

Main St.

300 W.

957'

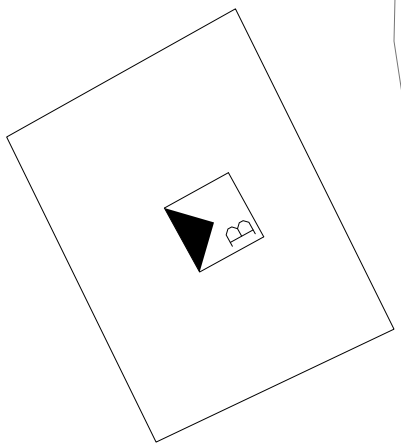

CentraCom, MC188111: Proposed conduit path to Mapleton City Hall, 125 W 400 North, Mapleton, UT.

